

# VAISHNODEVI INDUSTRIAL ESTATE PHASE - 2.

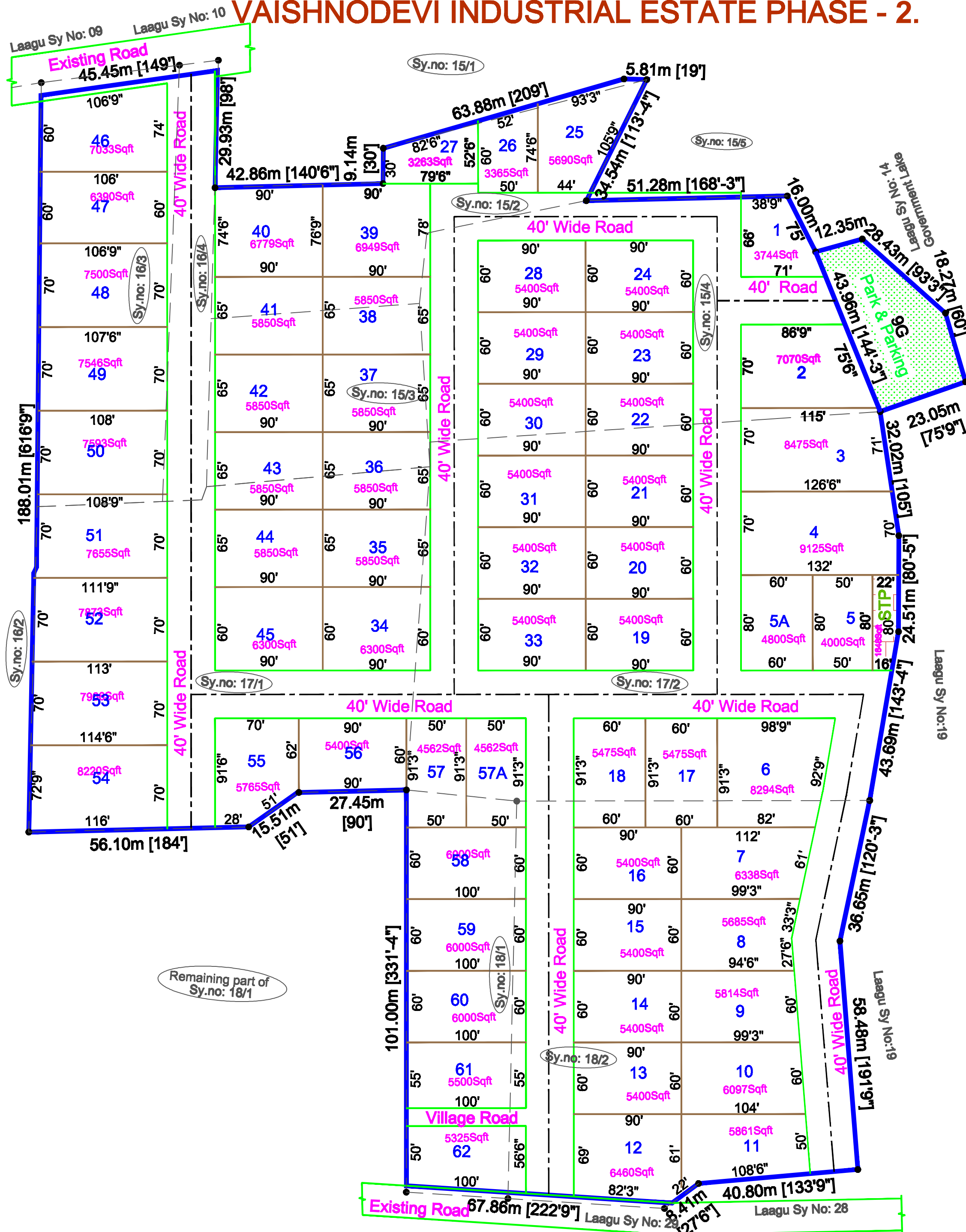

## VAISHNODEVI INDUSTRIAL ESTATE PHASE - 2.

Developed & Promoted By:

**VAISHNODEVI LUSH GREENS PRIVATE LIMITED**  
 # 13, Muthachari Industrial Estate, Nayandahalli,  
 Mysore Road, Bangalore - 560039.  
 E-mail: [info@vaishnodeviproperty.com](mailto:info@vaishnodeviproperty.com),  
 Phone: 080-23146429, Mobile: +919620799999

Proposed Industrial Layout Plan Showing in  
 15/2,3,4,16/3 & 4,17/1 & 17/2 & 18/1,18/2 at

Village: Beemenahalli  
 Hobli : Bidadi  
 Taluk : Ramanagaram.

### Amenities

01.	All sites are Vastu, Finalized Plan Concept Positioning 90 Degree Design.
02.	Metaling(metal) Road With Asphaltting (Tar)
03.	Construction of Storm water Drain Along With The Roads
04.	Sanitary Connection to Individual Site
05.	Plants are planted on all road sides
06.	Entrance Arch Main gate on South Road
07.	Providing Electrical Polls
08.	Construction of Compound wall-Security Type
09.	Leveling of Sites
10.	STP & Lying of Sewerlines

### Area Statement

47957.13Sqmt / 516206.28Sqft  
 Acres=11, Guntas=34.

Plot' s Area --381449.00Sqft --75.80%  
 Road Area --123294.00Sqft --24.00%  
 STP Area --1648.00Sqft --0.04%  
 Park Area --9801.00Sqft --0.16%

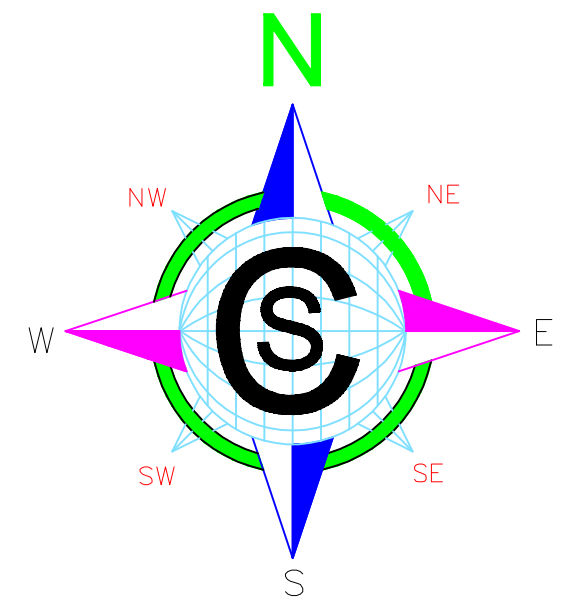

## S. ARUN KUMAR

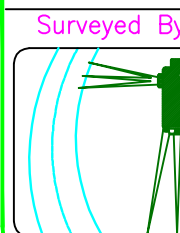

Surveyed By

**(SURVEY AND MAPPING CONSULTANTS)**  
 (Consultants for Revenue Survey Sketch Documentation,  
 Engineering Topographical Contour Land Surveys  
 & Architectural-Engineering Design Works)

# 88,1st Floor, "Shusheel Complex" 2nd Main, 8th Cross,  
 Above Syndicate Bank, Kengeri Satellite Town, Bengaluru - 560080.  
 MOB: 78999-77777, 98454-50622, 080-28488555  
 E-mail: [arun@arundhaticonstructions.com](mailto:arun@arundhaticonstructions.com)